

1904

120



2024



EQUIPMENT SOLUTIONS

***Welding torches &
personal protection equipment***



TBI Industries
Torches



TBi MIG/MAG welding torches

Three different product lines as core portfolio MIG/MAG – air cooled & water cooled

TBi Expert Mini: brand-quality product defined by a very small handle

- » **very lightweight air-cooled torches**
- » strongly compact handle, provides excellent solution for **welding in places where accessibility is difficult, ideal for tight workspaces**
- » reliable welding, even in difficult welding positions



TBi Exper Mini

TBi Expert: *highly reliable industrial welding torch series*

- » EURO style common wear parts
- » **optimized weight balance** of the complete torch system
- » slim 2-components handle with anti-slip rubber surfaces for convenient handling



TBi Expert

TBi T-Lux: *top welding torch series for demanding professionals*

- » precisely engineered **ergonomic handle design** and back-end connection
- » slim and ergonomic design ensures **fatigue-free handling**
- » **soft grip surface** provides a comfortable and **slip-proof handling**
- » **robust construction**
- » reduced strain on the welder's wrist due to optimized weight balance



TBi T-Lux



TBi T-Lux MIG/MAG Torches

TBi T-Lux MIG/MAG torches

Top welding torch series for demanding professionals

Our new premium TBi torch range aimed Customers who require increased performance

- » *Ergonomically upgraded handle*
- » Perfectly suitable for hand welding with *optimal balance*
- » *Durable soft grip surface* on the handle
- » Reliable grip and precise handling of the torch *even in forced positions*
- » Ball joint with rotation blockage *prevents torsion and twisting* of the cable assembly
- » *Top-quality wear parts* of high quality with industrial standard, optimized for high performance requirements
- » Variants with *double cooling system (CC)* or *Heavy-Duty frontend parts for high amperage welding (7G, 7W or 9W)*



TBi T-Lux MIG/MAG torches

Two lines

UNIQUE WEAR PARTS:

- » **Unique** heavy-duty products for air- and water-cooled torches, suitable for all market needs
- » **Screw-on gas nozzles**
- » Longer life wear parts
- » Numerous technical improvements
- » **TBi T-Lux models:** 7G-S, 7W-S, 7W-L, 9W-S, 9W-L, 9W-Alu

EURO STYLE WEAR PARTS:

- » **Common** wear parts
- » **Standard gas nozzles (interlocking)**
- » Standard range for most common applications
- » Performances range covers from 150 Amps air-cooled to 500 Amps water-cooled
- » **TBi T-Lux models:** 240, 250, 260, 360, 380, 241, 411, 511, 511-cc



TBi T-Lux MIG/MAG torches

Wide product range – air cooled & water cooled



TBi 240 T-Lux TBi 250 T-Lux TBi 260 T-Lux TBi 360 T-Lux TBi 380 T-Lux TBi 7G T-Lux

EURO style wear parts



TBi 241 T-Lux TBi 411 T-Lux TBi 511 T-Lux TBi 511-CC T-Lux

EURO style wear parts



TBi 7W-S T-Lux TBi 7W-L T-Lux TBi 9W-S T-Lux TBi 9W-L T-Lux TBi 9W-Alu T-Lux

Unique wear parts



TBi XP 363 T-Lux TBi XP 463 T-Lux

Unique wear parts



TBi Industries

TBi T-Lux TIG Torches



#9

Equipment Solutions
ESAB Mediterranean Region
Izmir, 21st October 2025



Proprietary & Confidential | ESAB Welding & Cutting Products



TBi T-Lux TIG torches

Top welding torch series for demanding professionals



TBi T-Lux TIG welding torches:

- » **Extraordinary ergonomic “pen-shape handle”** provides perfect comfort during welding
- » **durable soft grip surface** on the handle
- » common wear parts
- » single or multiple buttons
- » different remote-control modules available

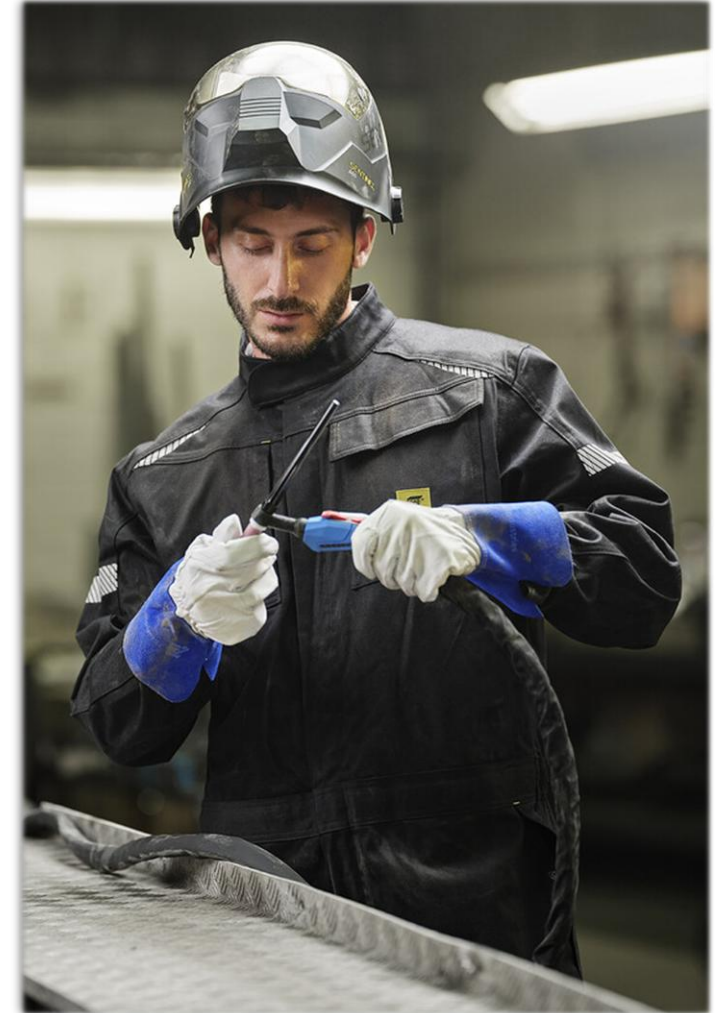

TBi T-Lux TIG torches

Highlight features

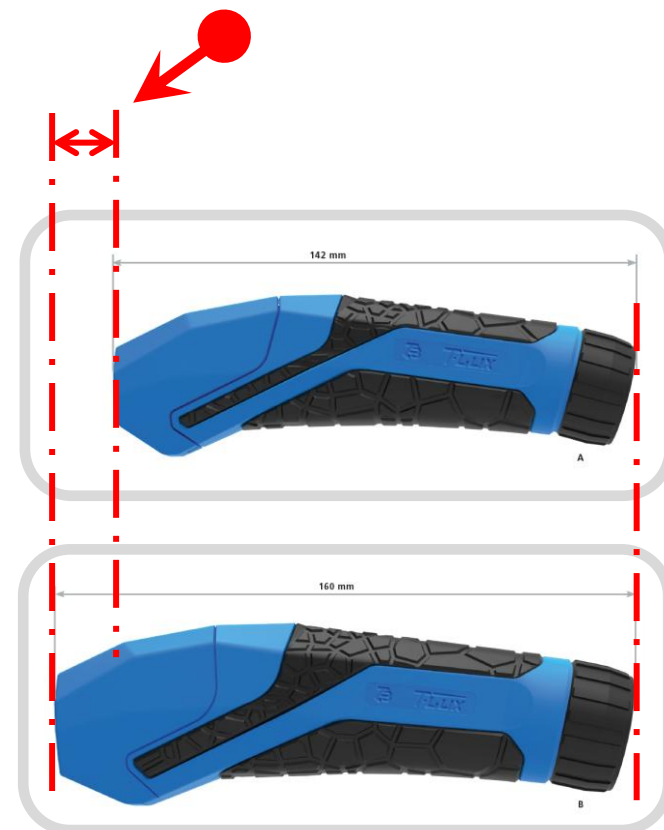
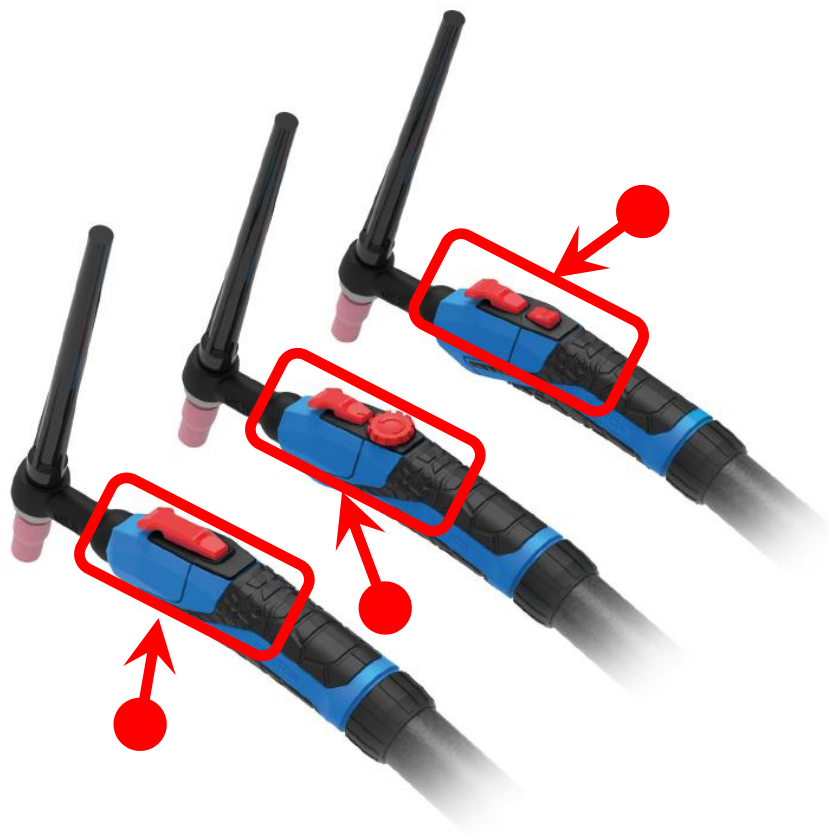

TBi T-Lux TIG torches

Wide product range



TBi SR 9 T-Lux
gas cooled
35% (10 min.)
AC: 100 A
DC: 145 A
Ø 0.5-1.6 mm



TBi SR 20 T-Lux
water cooled
100% (10 min.)
AC: 155 A
DC: 220 A
Ø 0.5-3.2 mm



TBi SR 21 T-Lux
water cooled
100% (10 min.)
AC: 240 A
DC: 340 A
Ø 0.5-3.2 mm



TBi XCT 400W T-Lux
water cooled
100% (10 min.)
AC: 315 A
DC: 450 A
Ø 1.6-4.0 mm

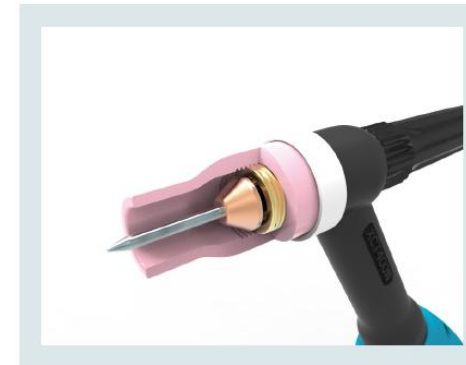

TBi SR 17 T-Lux
gas cooled
35% (10 min.)
AC: 120 A
DC: 170 A
Ø 0.5-2.4 mm



TBi SR X26 T-Lux
gas cooled
35% (10 min.)
AC: 180 A
DC: 260 A
Ø 0.5-4.0 mm



TBi SR FX26 T-Lux
gas cooled
35% (10 min.)
AC: 180 A
DC: 260 A
Ø 0.5-4.0 mm



TBi SR 18 T-Lux
water cooled
100% (10 min.)
AC: 225 A
DC: 320 A
Ø 0.5-4.0 mm

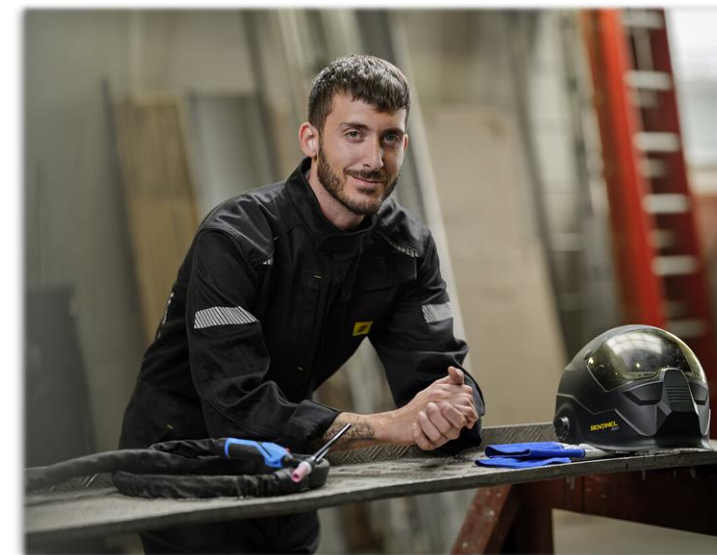



***TBi ANY1
TIG Torches***

TBi ANY1 TIG torches

Easy to adapt to different TIG welding machine brands, saving time and warehouse resources

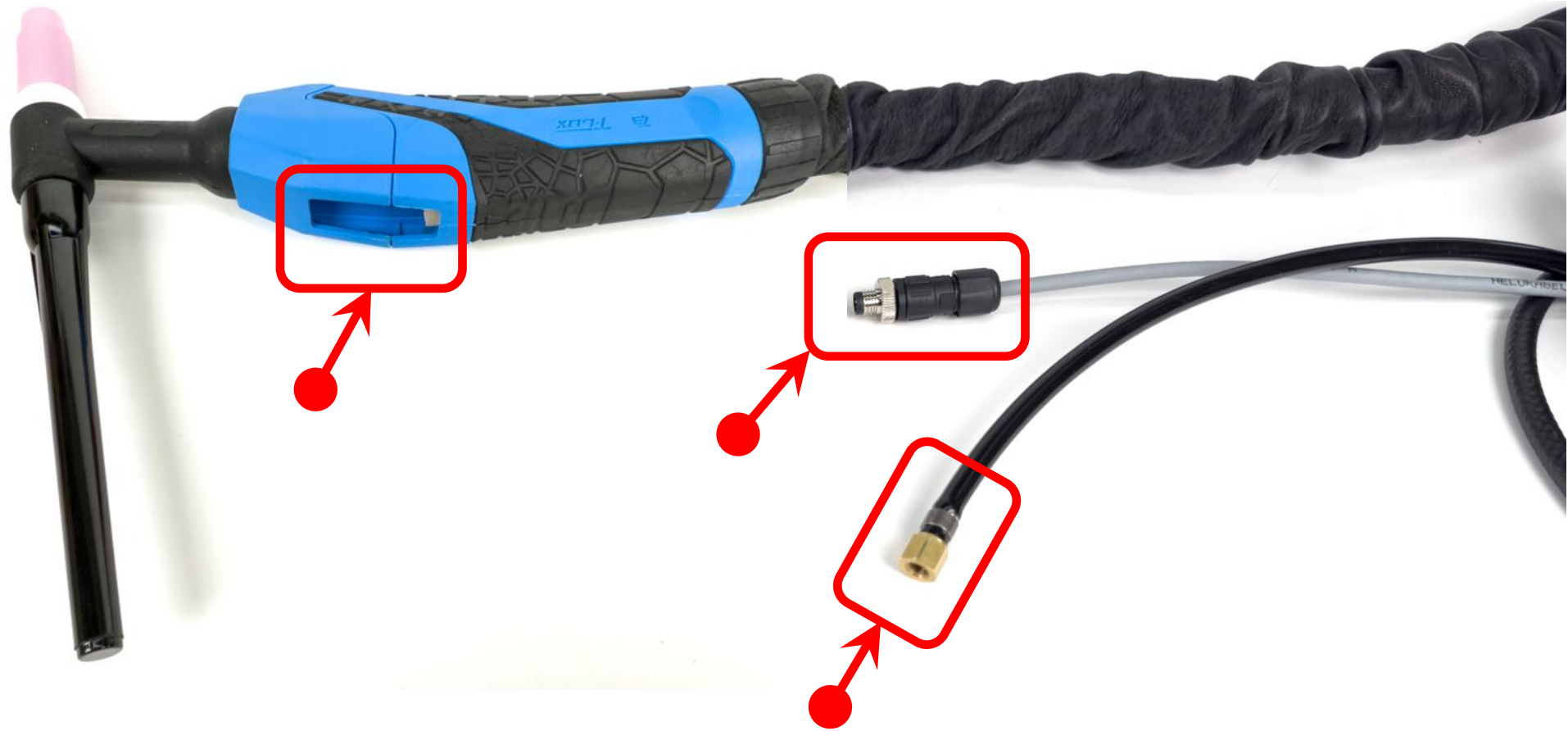

TBi ANY1 TIG torches

Ready to weld in no-time !!!



TBi ANY1 TIG torches

Ready to weld in no-time !!!

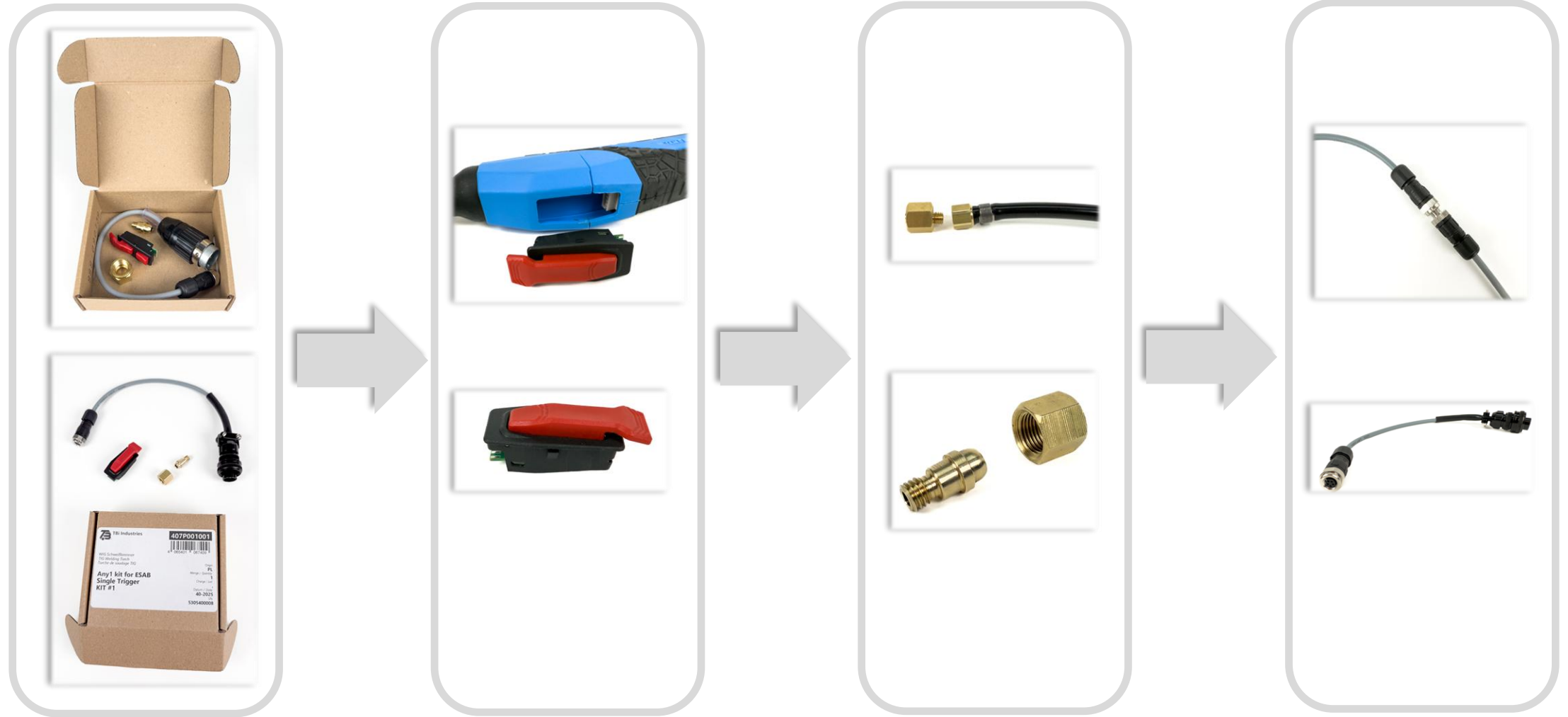

EXEOR

**ESAB EXEOR
PP 350w
INLINE PUSH-PULL
MIG/MAG TORCH**



#17

Equipment Solutions
ESAB Mediterranean Region
Izmir, 21st October 2025



Proprietary & Confidential | ESAB Welding & Cutting Products



NEW EXEOR PP350w TORCH FOR WARRIOR EDGE™

Highlight features

- » **True Plug'n'play coupled with Warrior Edge**
- » **Inline, excellent ergonomic design, light, slim and well balanced**
- » High duty cycle 350A @ 100%, water cooled
- » **Excellent wire feed stability**, controlled by **closed loop for optimal synchronization**
- » **Remote control mounted on the handle with display**, for easy parameter setting
- » **Robust 2-wheel driven feeding mechanism**
- » Longer lifetime on wear parts – well known PSF parts
- » Rotatable swan neck for good access. Easy-to-change.
- » Easy, intuitive pressure settings
- » Prepared for **pistol grip** (....coming soon!)

Please note !!

PP350w torch works **EXCLUSIVELY on Warrior Edge & RobustFeed Edge DX**. It will NOT fit on any other equipment. Not even trigger will work



NEW EXEOR PP350w TORCH FOR WARRIOR EDGE™

Design & maximum ergonomics

- » Straight, ergonomic handle.
- » One of the ***slimmest push-pull handles*** in the market
- » Size and balance are ***comparable to a regular MIG torch***
- » Light and easy to manoeuvre, especially in corners, narrow spaces or other challenging positions.
- » Rotatable neck for optimal reach
- » ***Snap-on pistol grip*** as accessory (...coming soon!)



NEW EXEOR PP350w TORCH FOR WARRIOR EDGE™

True plug'n'play with Warrior Edge™

- » PP350w and RobustFeed Edge™ DX is a unique, fully integrated solution:
 - No external sync box
 - No additional PCB / push-pull interface
 - No internal feeder adjustments
- » No additional required systems settings
- » No service technicians required to for install
 - True plug'n'play!
- » Push-pull torch is automatically recognized by the system.



**No synchronization units or
push-pull interface required**

NEW EXEOR PP350w TORCH FOR WARRIOR EDGE™

Extraordinary feeding performances

- » **Superior wire feeding performance up to 25 m/min**, even for challenging wires (e.g., 4xxx series).
- » **Closed-loop control of both push and pull feeders ensures perfect synchronization.**
 - Constantly targeting zero-offset between feeders for best welding performance.
 - Improves arc stability and start/stop behaviour.
- » System warnings by real-time monitoring of pull motor load and wire feed speed.
 - Two-level error system:
 - Warnings (continue welding)
 - Critical errors (stop welding).
 - Prevents motor overload or poor weld quality.

Standard setup. Also typical for sync boxes

Open Loop System



Closed Loop System

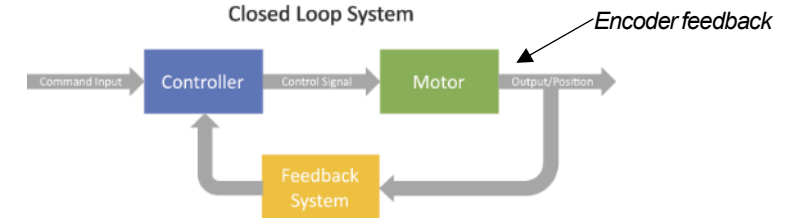

Warrior Edge / RobustFeed Edge DX / PP 350w setup

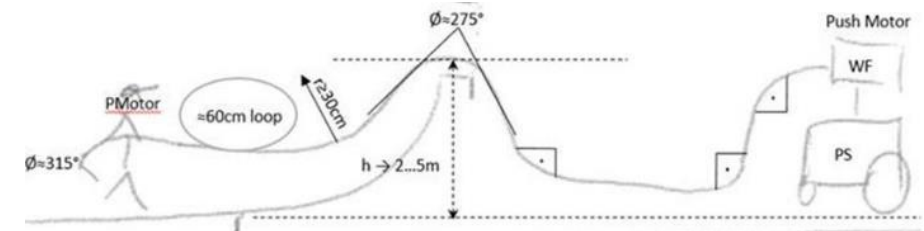

Lab setup simulating real-life feeding obstructions



***FE Fume Extraction
MIG/MAG torches***

FUME EXTRACTION MIG/MAG TORCHES FE

Highlight features

- » **Light weight** – One of the lightest fume extraction torches on the market
- » **Compact swan neck** and **front wear parts**
- » Ergonomic handle. **Excellent grip** compared to the often very clumsy fume extraction torches.
- » **Robust design**
- » High duty cycle
- » **Simple and robust wear part system – only 3 parts**
- » Combined gas nozzle and fume-shroud
 - **'Mini'** used on air cooled FE200, FE250 and water-cooled FE320w
 - **Standard** used on air cooled FE300 and water-cooled FE400



FUME EXTRACTION MIG/MAG TORCHES FE

Points of strength & differentiation

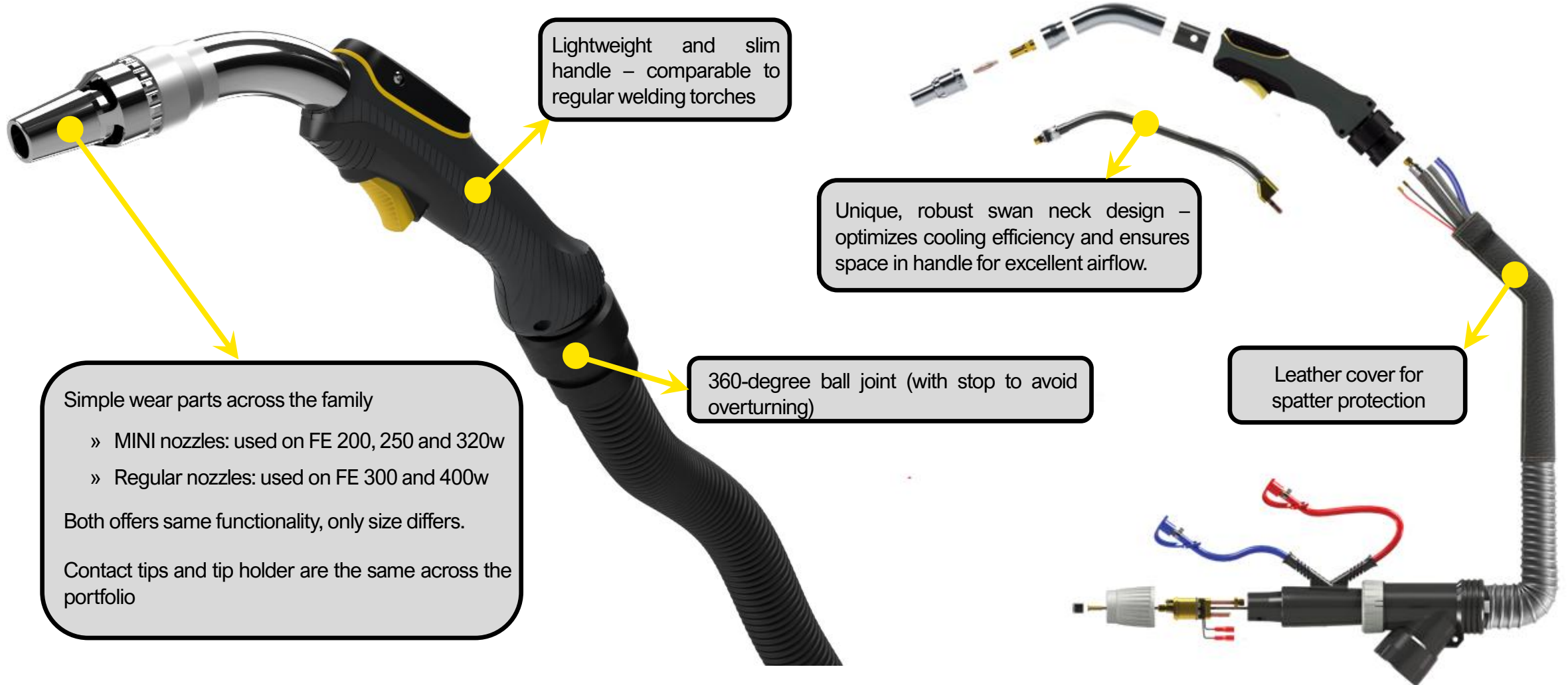

FUME EXTRACTION MIG/MAG TORCHES FE

Accessories and wear parts



FUME EXTRACTION MIG/MAG TORCHES FE

Wide product range

Specifications

	FE MINI 200	FE MINI 250	FE 300	FE MINI 320w	FE 400w
Cooling	Air	Air	Air	Liquid	Liquid
Welding Output M21	200 A at 60%	250 A at 60%	300 A at 100%	320 A at 100%	350 A at 100%
Welding Output CO ₂	230 A at 60%	280 A at 60%	320 A at 100%	360 A at 100%	390 A at 100%

FE Fume Extraction Torches

Ergonomic torches with excellent fume extraction capacity



Fume extraction torches are made to capture the welding fumes directly at the source. The FE torches are engineered to ensure excellent fume extraction performance without compromising the welding performance.

Featuring a good balance, an ergonomic handle design and a compact front end, these welding torches offer a comfortable feel similar to regular welding torches.

- Compact, ergonomic and lightweight design
- Long lifetime on wear parts
- Unique fume nozzle design for market leading extraction performance and durability
- Leather protection of cable assembly
- Use the optional airflow meter to ensure correct extraction flow for optimal welding- and fume extraction performance

Visit esab.com for more information.

Industry

- Automotive
- Light Fabrication
- Petrochemical
- Steel Industry
- Tank and Vessel Fabrication
- Ship and Offshore Yards
- Repair and Maintenance
- Steel Industry
- Industrial and General Fabrication



By using the airflow meter, the welder will immediately verify the airflow, ensuring both best fume extraction- and welding performance

FE Fume Extraction Torches

Specifications	FE MINI 200	FE MINI 250	FE 300	FE MINI 320w	FE 400w
Cooling	Air	Air	Air	Liquid	Liquid
Welding Output M21	200 A at 60%	250 A at 60%	300 A at 100%	320 A at 100%	350 A at 100%
Welding Output CO ₂	230 A at 60%	280 A at 60%	320 A at 100%	360 A at 100%	390 A at 100%
Rec. Gas Flow	15-18 l/min	15-18 l/min	16-18 l/min	15-18 l/min	16-18 l/min
Rec. Extraction Volume	55-80 m³/h	55-80 m³/h	55-80 m³/h	55-80 m³/h	55-80 m³/h
Underpressure Rate 50m/h*	10.5 kPa	10.5 kPa	8.5 kPa	10.5 kPa	9.5 kPa
Underpressure Rate 60m/h*	11.5 kPa	11.5 kPa	10.5 kPa	11.5 kPa	10.5 kPa
Weight**	1.08 kg	1.34 kg	1.59 kg	1.47 kg	1.68 kg
Rec. Wire Diameter	0.8-1.0 mm	0.8-1.2 mm	0.8-1.2 mm	0.8-1.6 mm	1.0-1.6 mm
Certification Mark	CE (IEC 60974-7)				
Cable Length	3 m, 4 m, 5 m				

*Torch length 4 meter

** Handling weight. Measured 1 meter from the ground.

Ordering Information	3 m	4 m	5 m
Description			
FE MINI 200 Torch	0700027000	0700027001	0700027002
FE MINI 250 Torch	0700027005	0700027006	0700027007
FE 300 Torch	0700027010	0700027011	0700027012
FE MINI 320w Torch	0700027015	0700027016	0700027017
FE 400w Torch	0700027020	0700027021	0700027022

Delivery includes: Instruction manual, one set of wear parts (1.0 mm on MINI torches, 1.2 mm on others), tool set and gasflow meter.

FE Fume Extraction Torches

Wear parts	Part Number
Description	
Nozzle, MINI, 12 mm, FE MINI 200, -250 and -320w	0700027055
Nozzle, MINI, 14 mm, FE MINI 200, -250 and -320w	0700027052
Nozzle, MINI, 17 mm, FE MINI 200, -250 and -320w	0700027053
Nozzle, 14 mm, FE 300 and FE 400w	0700027055
Nozzle, 17 mm, FE 300 and FE 400w	0700027056
Tip adapter MINI	0700027060
Tip adapter	0700027062

Boat: Included in delivery.

Contact tips	0.8 mm	1.0 mm	1.2 mm	1.6 mm
Description				
Contact tip ECu	0700027070	0700027071	0700027074	0700027077
Contact tip CuCrZr		0700027073	0700027076	0700027078
Contact tip for Aluminum		0700027072	0700027075	

Boat: Included in delivery.

Linners	3 m	4 m	5 m
Description			
Steel liner, Blue, 0.8 – 1.0 mm	0700020095	0700020096	0700020090
Steel liner, Red HD, 1.0 – 1.2 mm	0700025622	0700025623	0700025624
Steel liner, Grey HD, 1.4 – 1.6 mm	0700025623	0700025628	0700025627
PA/Bronze liner, Anthracite, 0.8 – 1.0 mm	0700025616	0700025617	0700025618
PA/Bronze liner, Anthracite, 1.2 – 1.6 mm	0700025619	0700025620	0700025621

Boat: Included in delivery.

Options & Accessories	Part Number
Description	
Airflow Meter MINI	0700027130
Airflow Meter	0700027131
Tool Set (brushwrench), cleaning and changing wear parts	0700027132
Hose adapter for ESAB CarryVac 3 (5 lmm hose)	0700027135
Gasflow Meter	0155716880
Coolant liquid 10 L	0405720002
Jig & Tool Protector, ceramic spray for nozzle and tip	0700013016

For full list of accessories, wear- and spare parts, please refer to instruction manual.



ESAB / esab.com



XA02001220-GL-EN-140224-ESAB reserves the right to alter product images and specifications without prior notice. Product images may not be an exact representation.

EXEOR

ESAB EXEOR TIG TORCHES FAMILY



#27

Equipment Solutions
ESAB Mediterranean Region
Izmir, 21st October 2025



Proprietary & Confidential | ESAB Welding & Cutting Products



EXEOR TIG TORCHES FAMILY

Slim, compact design with ergonomic handles & long trigger for a natural, easy control of the torch



EXEOR TIG TORCHES FAMILY

SR series – “pen-shape handle”, perfectly ergonomic



- » **Outstanding performance** in TIG welding applications
- » **Slim, compact design, ergonomic handles**
- » Soft grip zones for a safe and relaxed grip
- » Versatile choice, **convenience for all applications**
- » **Long trigger for a natural, easy control of torch in all hand positions**
- » Flexible head and on-torch remote current control (**options**)
- » **Plug & Play connection to your ESAB TIG machine without additional configuration**



EXEOR TIG TORCHES FAMILY

Highlight features for SR series

EXEOR SR-9



EXEOR SR-17



EXEOR SR-18



EXEOR SR-21



EXEOR TIG TORCHES FAMILY

Matching the “perfect ergonomic” vision of the Exeor brand



Natural access to the trigger due to the long design and possibility to active it both in front and back.

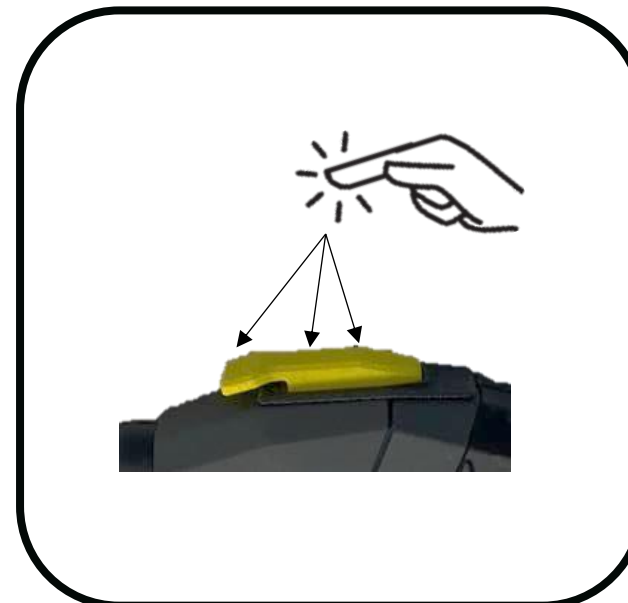
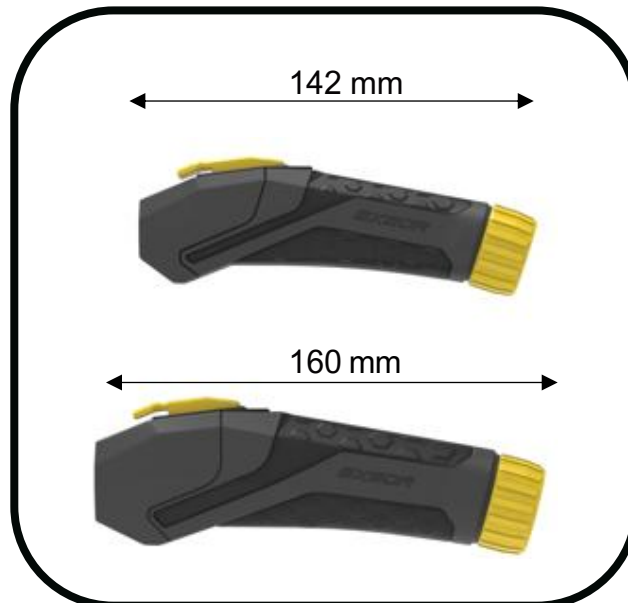

Control both trigger and potentiometer without changing hand position



EXEOR TIG TORCHES FAMILY

Wide product range for SR series



Ordering Information

	Handle	Connector	Module	Cooling	4 m	8 m
Exeor TIG SR 17	Small	8-pin	Trigger	Gas	0700026230	0700026231
Exeor TIG SR X26	Large	8-pin	Trigger	Gas	0700026250	0700026251
Exeor TIG SR 9	Small	2-pin	Trigger	Gas	0700026200	0700026201
Exeor TIG SR 9 FX	Small	2-pin	Trigger	Gas	0700026202	0700026203
Exeor TIG SR 17	Small	2-pin	Trigger	Gas	0700026220	0700026221
Exeor TIG SR 17 FX	Small	2-pin	Trigger	Gas	0700026222	0700026223
Exeor TIG SR X26	Large	2-pin	Trigger	Gas	0700026240	0700026241
Exeor TIG SR X26 FX	Large	2-pin	Trigger	Gas	0700026242	0700026243
Exeor TIG SR 18	Large	2-pin	Trigger	Liquid	0700026280	0700026281
Exeor TIG SR 18 FX	Large	2-pin	Trigger	Liquid	0700026282	0700026283
Exeor TIG SR 21	Small	2-pin	Trigger	Liquid	0700026290	0700026291
Exeor TIG SR 21 FX	Small	2-pin	Trigger	Liquid	0700026292	0700026293
Exeor TIG SR 400	Large	2-pin	Trigger	Liquid	0700026310	0700026311

Potentiometer versions for Rebel-, Rogue ET-, Renegade ET*- and Fabricator ET-series

Exeor TIG SR 9-R	Small	8-pin	Potentiometer	Gas	0700026214	0700026215
Exeor TIG SR 17FX-R	Small	8-pin	Potentiometer	Gas	0700026236	0700026237
Exeor TIG SR X26-R	Large	8-pin	Potentiometer	Gas	0700026254	0700026255
Exeor TIG SR 18-R	Large	8-pin	Potentiometer	Liquid	0700026284	0700026285
Exeor TIG SR 21-R	Small	8-pin	Potentiometer	Liquid	0700026294	0700026295
Exeor TIG SR 21FX-R	Small	8-pin	Potentiometer	Liquid	0700026296	0700026297

* Not applicable for Rebel EMP 215iC, and Renegade ET 300i/300iP.

FX = Flexible head, R = Potentiometer for remote control

EXEOR TIG TORCHES FAMILY

XCT Series – excellent performance, extremely compact unique design

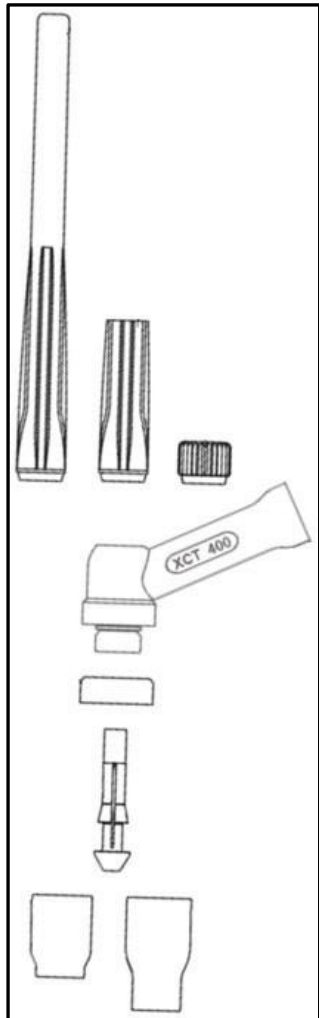

Specifications

	XCT 200w	XCT 400w
Welding Output (10 min)	100% 175 A AC 250 A DC	100% 315 A AC 450 A DC
Rec. Electrode Diameter	1.6-4.0 mm	1.6-4.0 mm
Cable Length	4 m, 8 m	4 m, 8 m
Cooling	Liquid	Liquid

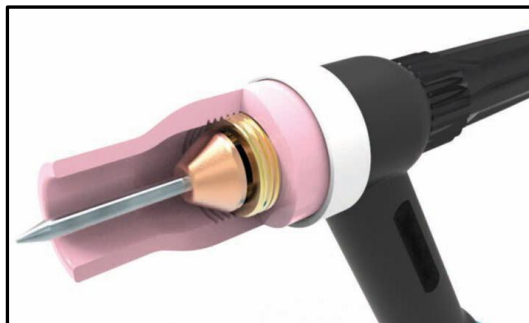

Ordering Information

	Handle	Connector	Module	Cooling	4 m	8 m
Exeor TIG XCT 200w	Small	2-pin	Trigger	Liquid	0700026230	0700026231
Exeor TIG XCT 400w	Small	2-pin	Trigger	Liquid	0700026334	0700026335

EXEOR TIG TORCHES FAMILY

TM MultiLock Series – TIG welding torches with articulated head on two joints



Specifications		
	TM 125 (with SR 9/21 head)	TM 250 (with SR 9/21 head)
Welding Output (10 min)	35% 120 A AC 170 A DC	100% 155 A AC 220 A DC
Rec. Electrode Ø	0.5-2.4 mm	0.5-3.2 mm
Cable Length	4m, 8 m	4m, 8 m
Cooling	Gas	Liquid



EXEOR TIG TORCHES FAMILY

TM MultiLock Series – Product range



Ordering Information

	Handle	Connector	Module	Cooling	4 m	8 m
Exeor TIG TM 125	Small	2-pin	Trigger	Gas	0700026260	0700026261
Exeor TIG TM 250	Small	2-pin	Trigger	Liquid	0700026320	0700026321

Potentiometer versions for Rebel-, Rogue ET-, Renegade ET*- and Fabricator ET series

Exeor TIG TM 125-R	Small	8-pin	Potentiometer	Gas	0700026274	0700026275
Exeor TIG TM 250-R	Small	8-pin	Potentiometer	Liquid	0700026324	0700026325

* Not applicable for Rebel EMP 215iC and Renegade ET 300i/300iP.

R = Potentiometer for remote control

Please see separate fact sheet for wear parts.

Accessories

MultiLock Torch Head, SR 9/20/21	402P550002
MultiLock Torch Head, SR 17/18/26	402P550003

Standard MultiLock torches comes with SR9/20/21 torch head and consumables for 2.4mm wear part kit.

EXEOR

ESAB EXEOR PSF MIG/MAG TORCHES FAMILY

#36

Equipment Solutions
ESAB Mediterranean Region
Izmir, 21st October 2025



Proprietary & Confidential | ESAB Welding & Cutting Products



EXEOR PSF MIG/MAG TORCHES

MIG/MAG industrial series with Exeor handle for better ergonomic handling with excellent balance and strong grip

- » **What's changed:** the EXEOR PSFs now comes with the new EXEOR handle
 - Excellent ergonomic shape
 - Durable, soft grip zones, inlay moulded into hard component for improved durability
- » **What's not changed:**
 - Everything else: cable assemblies, Euro connector, swan necks and wears remains as they are on current PSFs.



**AIR
COOLED**



**WATER
COOLED**



EXEOR PSF MIG/MAG TORCHES

Points of strength & differentiation

What's different than the PSF MIG torches ?

- » Much more **compact design**
- » **Smaller knuckle joint** resulting in better grip on back end of the handle
- » **Only 3 screws for easy repair**
- » More 'curved-shape' for better ergonomic grip and better balance
- » **More robust soft grip areas**
- » More visible branding options
- » Optional rubber/spring strain relief



EXEOR PSF MIG/MAG TORCHES

Wide product range

Specifications				
Description	PSF 260	EXEOR PSF 315	EXEOR PSF 415	EXEOR PSF 515
Cooling	Gas			
Welding Output Mixed Gas	225 A at 60%	260 A at 60%	280 A at 60%	360 A at 60%
Welding Output CO ₂	250 A at 60%	290 A at 60%	310 A at 60%	390 A at 60%
Wire Diameter	0.6 – 1.0 mm	0.8 – 1.2 mm	0.8 – 1.6 mm	1.0 – 1.6 mm
Certification Mark (Standards)	CE (IEC 60974-7)			
Operating Temperature	-10 to +40 °C			
Cable Length	3 m, 4 m, 5 m			

**AIR
COOLED**

Specifications			
Description	PSF 420W	PSF 430W	PSF 520W
Cooling	Liquid	Liquid, dual-circuit	Liquid, dual-circuit
Welding Output Mixed Gas	400 A at 100%	450 A at 100%	500 A at 100%
Welding Output CO ₂	400 A at 100%	450 A at 100%	500 A at 100%
Wire Diameter	0.8 – 1.6 mm	1.0 – 1.6 mm	1.0 – 1.6 mm
Certification Mark (Standards)	CE (IEC 60974-7)		
Operating Temperature	-10 to +40 °C		
Cable Length	3 m, 4 m, 5m		

**WATER
COOLED**

PSF EXEOR MIG 430w & PSF EXEOR MIG 520w

Dual cooling circuit for best performances

- » **EXEOR PSF 430w MIG torch:** performance 450 Amps @ 100% DC, same wear parts as PSF 420w
- » **EXEOR PSF 520w MIG torch:** performance 500 Amps @ 100% DC, larger wear parts than PSF 420w / 430w
- » **Both of them:**
 - Two-circuit heavy duty cooling system
 - Well balance between performance and size of wear parts
 - Improvement welder's safety against the risk of burns due to the powerful neck cooling system



Exeor PSF 430w



Exeor PSF 520w

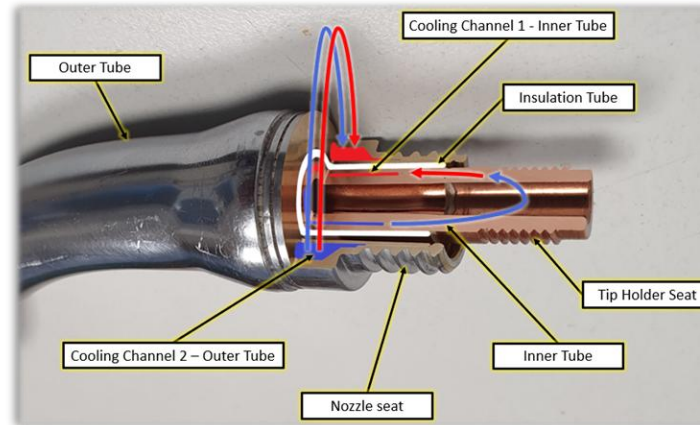
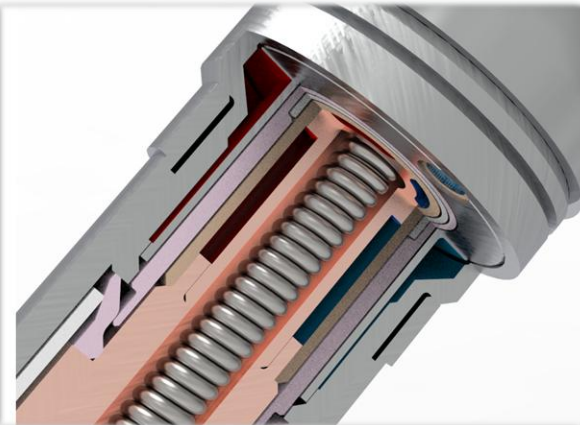

EXEOR

SPECIAL ESAB EXEOR MIG/MAG TORCHES

WARRIOR EDGE II

#41

Equipment Solutions
ESAB Mediterranean Region
Izmir, 21st October 2025



Proprietary & Confidential | ESAB Welding & Cutting Products



EXEOR MIG 4.0W2 CX & EXEOR MIG 4.0W2 DX

Water-cooled torches with unique performances



Remote control
integrated in
EXEOR torch
handle, only for
WARRIOR EDGE



Torches Exeor MIG			
Description	3m	4m	5m
Torch Exeor MIG 4.0G ² , Gas Cooled *	0700026056	0700026057	0700026058
Torch Exeor MIG 4.0G ² CX, Gas Cooled, Up/down **	0700025755	0700025756	0700025757
Torch Exeor MIG 4.0G ² DX, Gas Cooled, Graphic Display***	0700025758	0700025759	0700025760
Torch Exeor MIG 4.0W ² , Water Cooled *	0700026050	0700026051	0700026052
Torch Exeor MIG 4.0W ² CX, Water Cooled, Up/down **	0700025730	0700025731	0700025732
Torch Exeor MIG 4.0W ² DX, Water Cooled, Graphic display ***	0700025733	0700025734	0700025735

* Torch with enhanced cooling performance. No Torch LED light.

** Torch with enhanced cooling performance. Includes Torch LED light and CX remote for JOB selection / WFS / V / 2T-4T

*** Torch with enhanced cooling performance. Includes Torch LED light and DX graphical display remote for JOB selection / WFS / V / 2T-4T / Measure values / Arc Dynamics

EXEOR MIG 4.0W2 DX

Water-cooled torch with unique performances

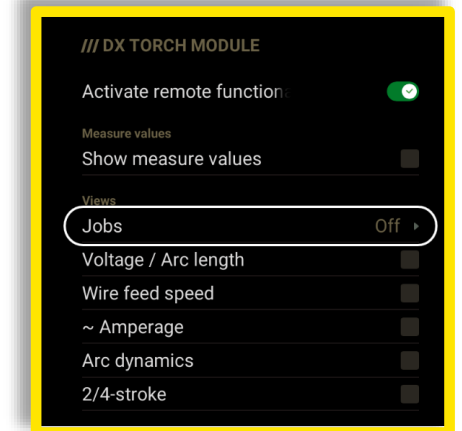

SPECIAL EXEOR MIG/MAG TORCHES

Air-cooled torches with unique performances

EXEOR PSF MIG 315 R4

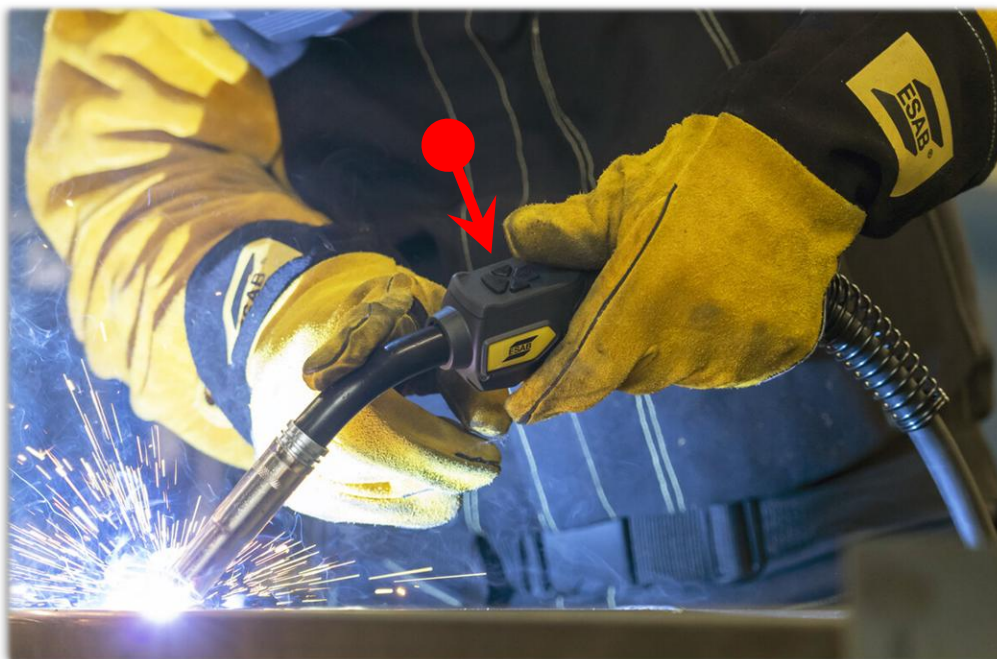

EXEOR MIG 3.0G-S CX

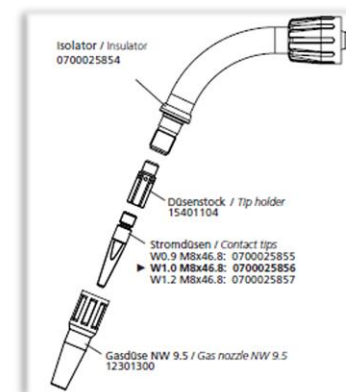

SAVAGE
A41



SAVAGE
A41

#45

Equipment Solutions
ESAB Mediterranean Region
Izmir, 21st October 2025



Proprietary & Confidential | ESAB Welding & Cutting Products



SAVAGE A41

Highlight features

SAVAGE

A41

- » **NEW** all-internal digital user interface
- » Simple push-buttons
- » Clear dual-colour LED light display
- » Shade range: from 8-13
- » 6-step Delay and Sensitivity selection



SAVAGE A41

Highlight features

- » **SAME** familiar Savage **A40** shape and style
- » **LOW PROFILE** external grind button
 - No more external knobs
 - Same 2-second push-button actuation
- » **IDENTICAL** replacement parts as the A40
 - Headgear
 - Internal / external lenses
 - Magnifier lenses
 - NO replacement ADF (same as Savage A40)
- » **IDENTICAL** Savage A40 Air with PAPR system
 - Overhead ventilation built into the headgear
 - EPR-X1.1 certified to TH3P level filtration

SAVAGE
A41



SAVAGE
A41air



SAVAGE A41

Points of strength & differentiation

- » **NEW internal digital interface**, simple to use with clear information feedback
- » **External grind button** mounted to left side of helmet
- » Wide range **8 – 13 DIN shade** selection
- » Multi-point basic headgear adjustment
- » Passive state shade 4
- » **Excellent True-Colour performance**
- » 4 IR sensors
- » Great industrial design
- » Available in **black** or **yellow shell colours**



SAVAGE
A50 LUX

SAVAGE
A50 LUX



#49

Equipment Solutions
ESAB Mediterranean Region
Izmir, 21st October 2025



Proprietary & Confidential | ESAB Welding & Cutting Products



SAVAGE A50 LUX

Convenient smart light LED to illuminate the work area !!



SAVAGE A50 LUX

Highlight features

Savage A50 LUX Air



- » The A50 LUX helmet delivers strong **premium performance** in a **unique ESAB design**
- » ADF clarity matches best-in-class
- » ADF user interface: **premium in look and function**
- » Lightweight shell is 100% built on Sentinel's proven balance
- » **Advanced Halo headgear** is the same as used in Sentinel

Savage A50 LUX

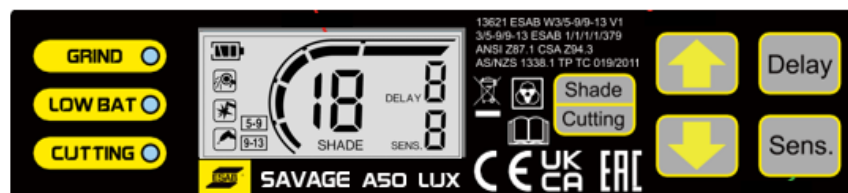

SAVAGE A50 LUX

Front lens – fast removing and replacing

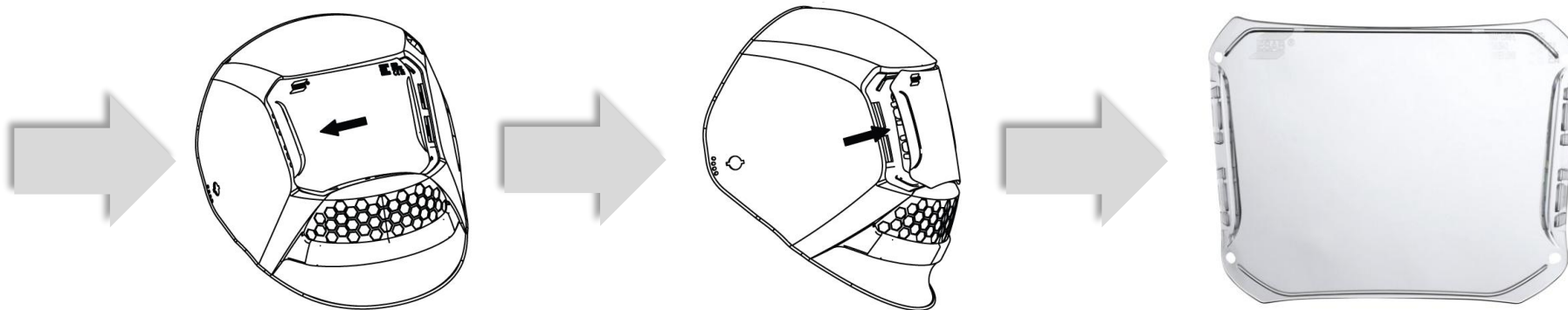
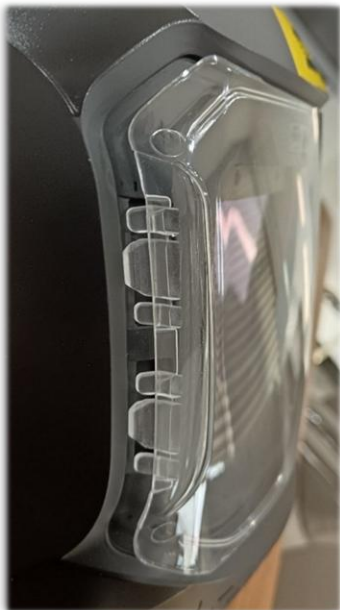

Unique and simple front lens attachment system using shaped ridges to grasp the lens with thumb and finger, gently squeeze to remove or install.



WELD IN A NEW LIGHT

See clearly, work confidently.

SAVAGE
A-50LUX

- DUAL-LED WORK LIGHT FOR DARK ENVIRONMENTS
- ESAB OpTCS™ TRUE-COLOR ADF
- PERFECT 1/1/1/1 CLARITY

CRAFTED FOR COMFORT

Clean lines, perfect fit.

SAVAGE
A-50LUX

- LIGHTWEIGHT LOW-PROFILE DESIGN
- 5-POINT ADJUSTABLE ESAB HALO™ HEADGEAR
- IMPACT-RESISTANT NYLON SHELL

HIGH-TECH HIGHLIGHTS

Dive into the details that matter.

- LOW-PROFILE EXTERNAL GRIND MODE AND WORK LIGHT BUTTONS
- RECESSED, QUICK-RELEASE COVER LENS
- SMART LED WORK LIGHT: TURNS OFF DURING WELDING
- 4 LIGHT SENSORS FOR FASTER AUTO DARKENING

SAVAGE
A-50 LUX

PINPOINT CONTROL

Get dialed in.

- DIN 3/5-13 SHADE RANGE
- GLOVE-FRIENDLY PUSH BUTTON CONTROLS
- EASY-TO-READ DIGITAL DISPLAY

SAVAGE
A-50 LUX

SENTINEL™



SENTINEL™

A-60

#55

Equipment Solutions
ESAB Mediterranean Region
Izmir, 21st October 2025



Proprietary & Confidential | ESAB Welding & Cutting Products



A60 SENTINEL

Top performances welding helmet !!



A60 SENTINEL – ***TWO LIMITED EDITIONS***

Top performances welding helmet !!

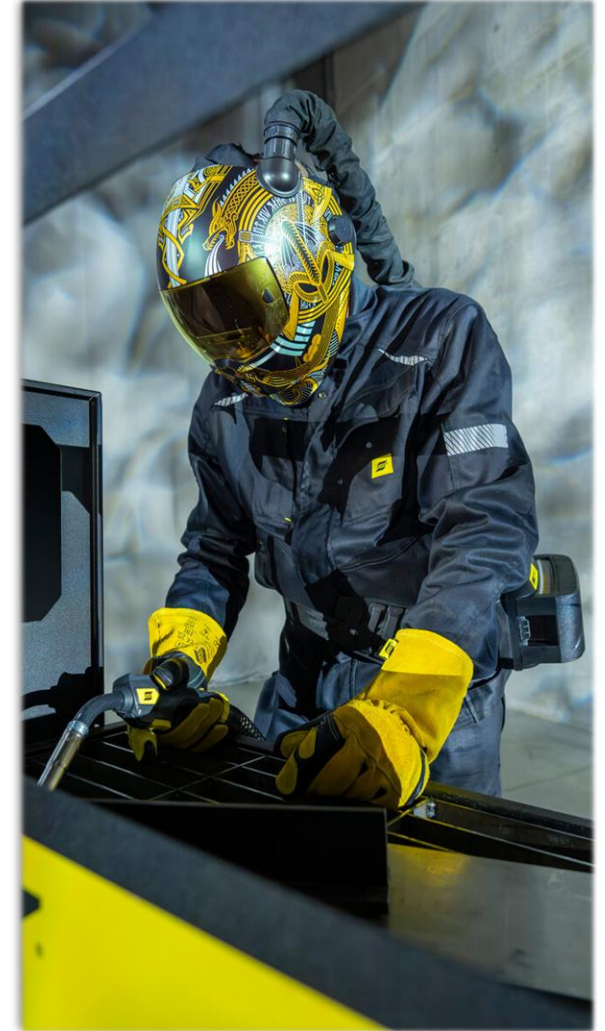

LCD CONTROL PANEL

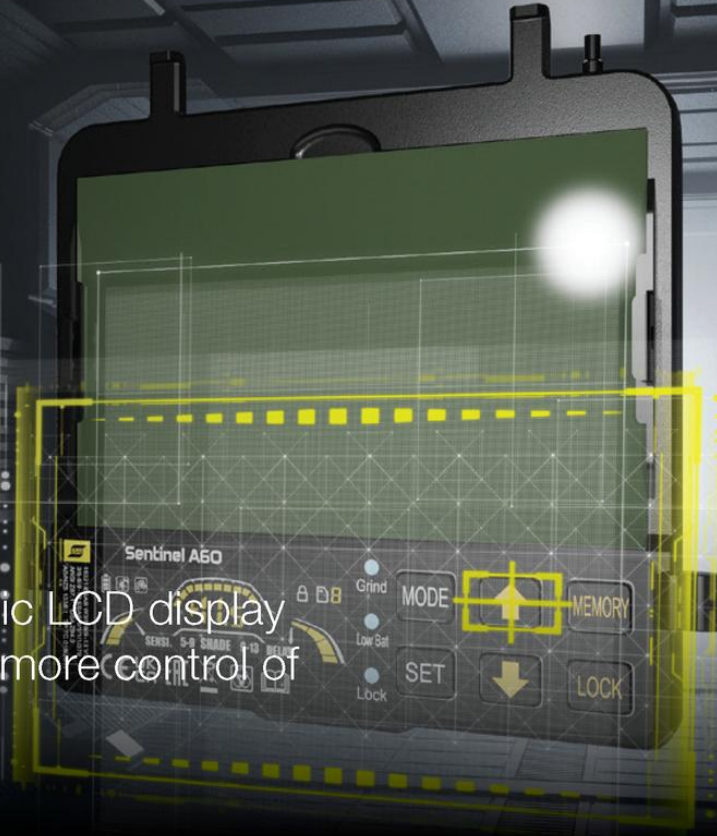

- **High-definition** Graphic LCD display
- **Intuitive interface** for more control of shade and sensitivity

SENTINEL™ A60

EXTERNAL GRIND MODE CONTROL



- **Easily engage grind mode** even while wearing a heavy welding glove
- **Engage grind mode** without having to remove helmet

SENTINEL™ A60

HIGHEST OPTICAL CLARITY



40% LARGER
VIEWING AREA

- EN 1/1/1/1 **Rated Lens**
- ESAB OpTCS™ **True Color ADF**

SENTINEL™ A-60

ERGONOMIC HEADGEAR



- **Customizable**
with 5-way adjustability
- **Comfort** for all day welding

SENTINEL™ A-60

SAVAGE A41 vs SAVAGE A50 LUX vs SENTINEL A60

Head-to-head



- » True-colour ADF
- » Unique shell aesthetic, based on Sentinel
- » External grind buttons mounted to left side of helmet
- » Fully internal digital user interface with simple push-buttons
- » Shade 8- 13 DIN
- » Passive state shade 4 DIN
- » Multi-point basic headgear adjustment



- » 2nd Gen, proprietary Optics™ true-colour ADF
- » Next-gen shell aesthetic – ESAB ID
- » Fully internal digital user interface with two external dedicated buttons for grind mode and light-on mode
- » Shade 5 – 13 DIN
- » Passive state shade 3 DIN
- » Sentinel 5-point adjustable Halo headgear
- » LED light feature



- » 2nd Gen, proprietary Optics™ true-colour ADF
- » Proven Sentinel shell design
- » Fully internal digital user interface with external dedicated grind button
- » Advanced digital user interface
- » Shade 5 – 13 DIN
- » Passive state shade 3 DIN
- » Sentinel 5-point adjustable Halo headgear

L-30 Laser Welding Helmet



Laser Welding Helmet L-30

Challenges of handheld laser safety

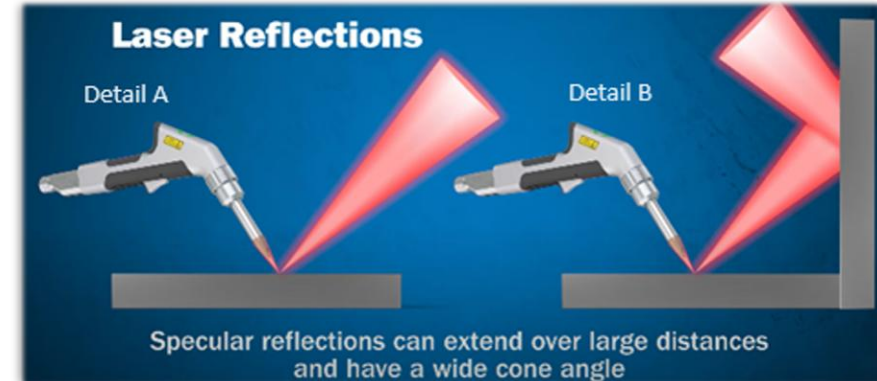
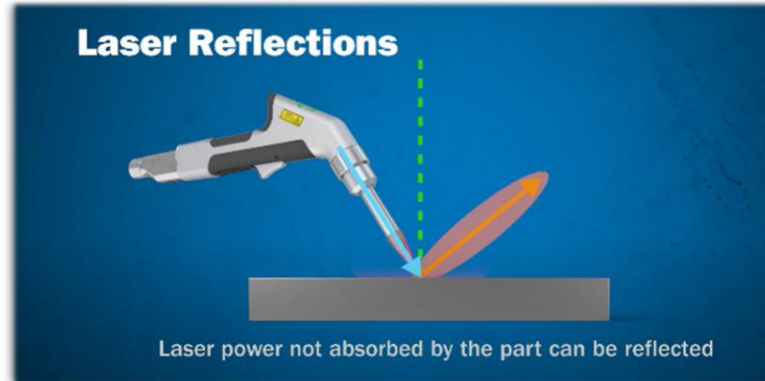

Industrial Hazard Safety Assessments Generalized hazards – Beam control

- » Laser intensity retains most of its energy when reflected, so it's still capable of serious injury
 - Recent reports indicate that welders are not aware of when they are exposed to reflected beams
 - Reflected beams affect more than the welder. Bystanders and objects can be easily damaged by reflected beams

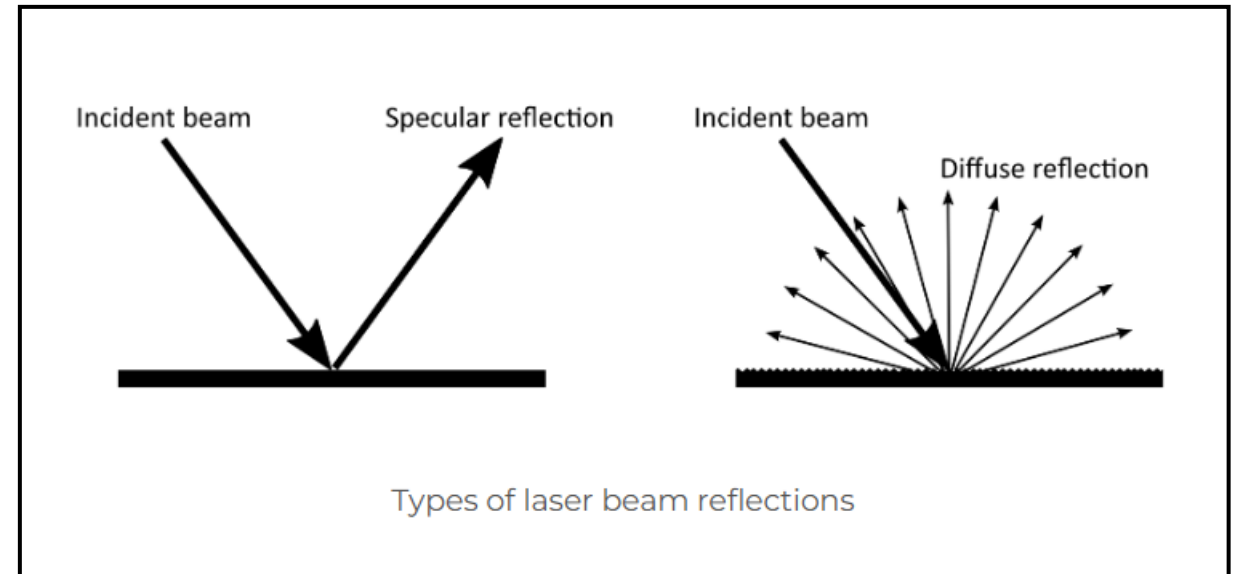

Laser Welding Helmet L-30

Highlight features

- » Five adjustable shade settings
- » Large viewing area
- » Intuitive digital interface makes shade adjustments fast and easy.
- » Full EN 207 certifications for optical filter and shell
- » Carbon fibre front shell
- » Carbon fibre filter bracket
- » Multi-point adjustable headgear
- » Suitable for 900-1100 nm wavelength

NOT FOR ARC WELDING !!!



Specifications	
Viewing Area	100 x 60 mm (3.93 x 2.36 in.)
Lens Shade	Adjustable: DIN 2.5 (VLT 25%); 3 (VLT 15%); 3.5 (VLT 10%); 4 (VLT 5%); 5 (VLT 2%)
Power Supply	Solar cell, Replaceable Battery (1*CR2450 lithium). Alerts when low battery.
Certification - FILTER	EN ISO 16321 ESAB W2.5/3/3.5/4/5 V2; EN 207 900-1080 D LB7 IR LB8 CE AS/NZS ESAB W2.5/3/3.5/4/5 S 900-1080 OD7 C5 PS3 ISO 19818-1 ESAB
Certification - SHELL	EN ISO 16321 ESAB W15 EN 207 900-1100nm D LB7 IR LB8 CE ESAB AS/NZS 1337.1 B 1000-1100 OD7 C5 PS3 ISO 19818-1 ESAB E
Warranty	2 years
Weight	648 g (1.4 lbs)



EPR-X1.1

Powered Air Purifying Respirator



OPTIONAL



A1B1E1 TH3P combination filter
available separately





Personal Protection Equipment

#66

Equipment Solutions
ESAB Mediterranean Region
Izmir, 21st October 2025



Proprietary & Confidential | ESAB Welding & Cutting Products



WELDING GARMENTS MW2000

Mid-weight FR clothing



- » FR material with 2-way stretch
- » Shielded metal zippers for easy and secure closure
- » Convenient and protected pockets for secure tool storage
- » Reflective accents for enhanced visibility and safety
- » Retains FR properties for up to 50 wash cycles



WELDING GARMENTS MW2000

Mid-weight FR clothing

FR Jacket MW2000



FR Coveralls MW2000



FR Trousers MW2000



Heavy Duty Gloves

MIG / MMA Glove Range



M1050



M2000



M3050

Durable, premium split leathers to withstand MIG / MMA welding for heavy duty use:

- » Kevlar® stitching throughout
- » Weltd seams
- » Reinforced thumb on M3050
- » Wide split leather cuffs allow fast removal
- » Strategically-placed ***cushioning*** on M3050

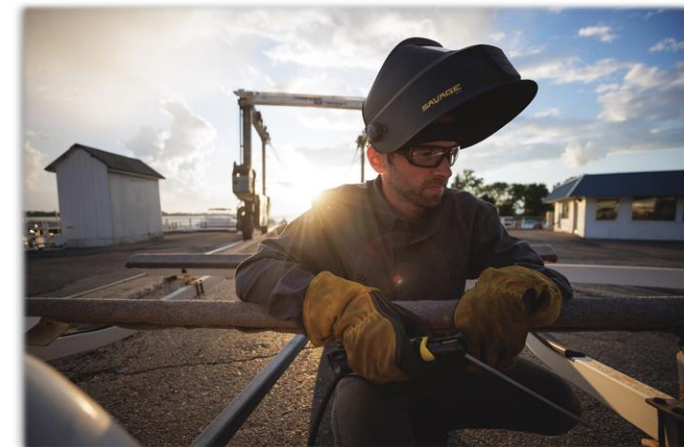

TIG Gloves

TIG Glove Range



T1000



T2000



T3000



- » Unlined for maximum comfort and feel
- » **Premium goatskin hand** on T1000
- » **Premium sheepskin hand** on T2000 and T3000
- » Strategically-placed **cushioning** on T2000 and T3000
- » Gauntlet designed for easy donning and doffing



THANK YOU !



LORENZO BALDASSARRE
Product Manager Equipment Solutions
ESAB Med Region



UMUT GÜRBİY
Sales Engineer
ESAB Med Region

ESAB MEDITERRANEAN REGION



VICTOR® // THERMAL DYNAMICS® // TWECO® // ARCAIR® // EXATON™ // STOODY® // ALCOTEC® // AMI®